

- U : Phase U
- V : Phase V
- W : Phase W
- TH- : Thermic protector
- TH+ : Thermic protector
- BR- : No connection
- BR+ : No connection
- S1 : Resolver 1
- S2 : Resolver 2
- S3 : Resolver 3
- S4 : Resolver 4
- R1 : Resolver 5
- R2 : Resolver 6
- B : Shield option (screw M3)
- ⊕ : Ground

PRINTED CIRCUIT (under the cap)

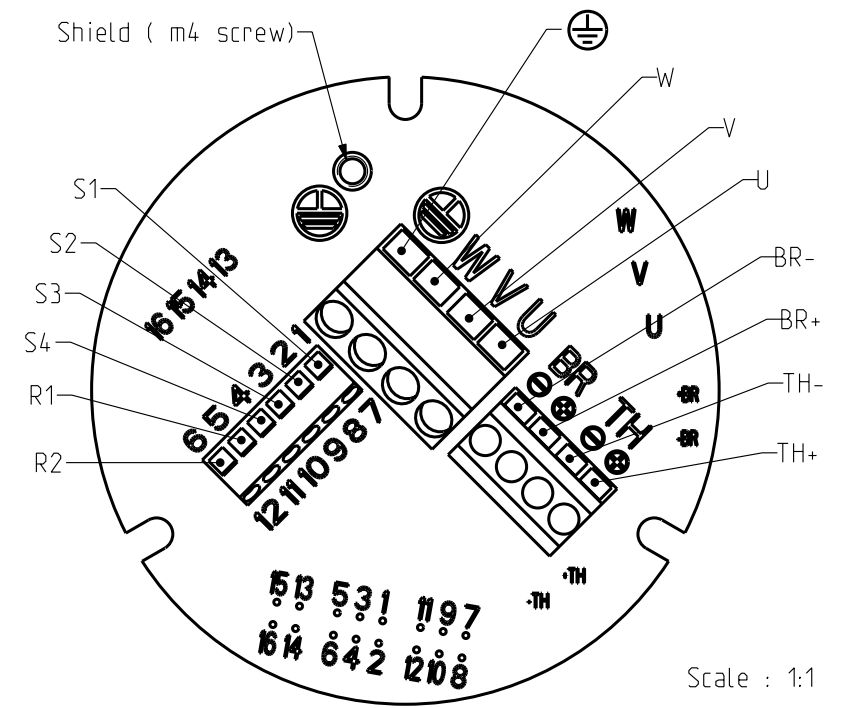

Protection II 2 G EEx d II B T4 :
 * EN 50014 : GENERAL RULES
 * EN 50018 : FLAMEPROOF "d"
 Certification : INERIS **ATEX****X

DIMENSIONS

	EX620	EX630
L Maxi	300	325
B	260	285

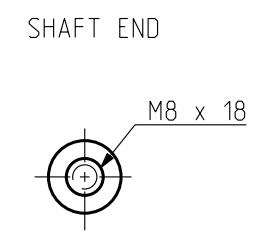

Drawing valid for : -

Weight :
 This document is the property of PARVEX. Transmission as well as reproduction or copy is not permitted without written authorisation.

Drawn	12/03/04	SP	Visa					
Modifications	b	AM 21881 le 08/02/05	SP					
	a	AM 21794 le 09/11/04	SP					

Scale: 2:5

PARVEX
 8 Avenue du lac. BP249
 21007-DIJON cedex-FRANCE
 www.parvex.com

EX600
 OUTLINE DRAWING

Format	F	E	S	G	I
A3	x	x			
344550AE1500					b