

- U : Phase U
- V : Phase V
- W : Phase W
- TH- : Thermic protector
- TH+ : Thermic protector
- BR- : Brake -
- BR+ : Brake +
- S1 : Resolver 1
- S2 : Resolver 2
- S3 : Resolver 3
- S4 : Resolver 4
- R1 : Resolver 5
- R2 : Resolver 6
- B : Shield option (screw M3)
- ⊕ : Ground

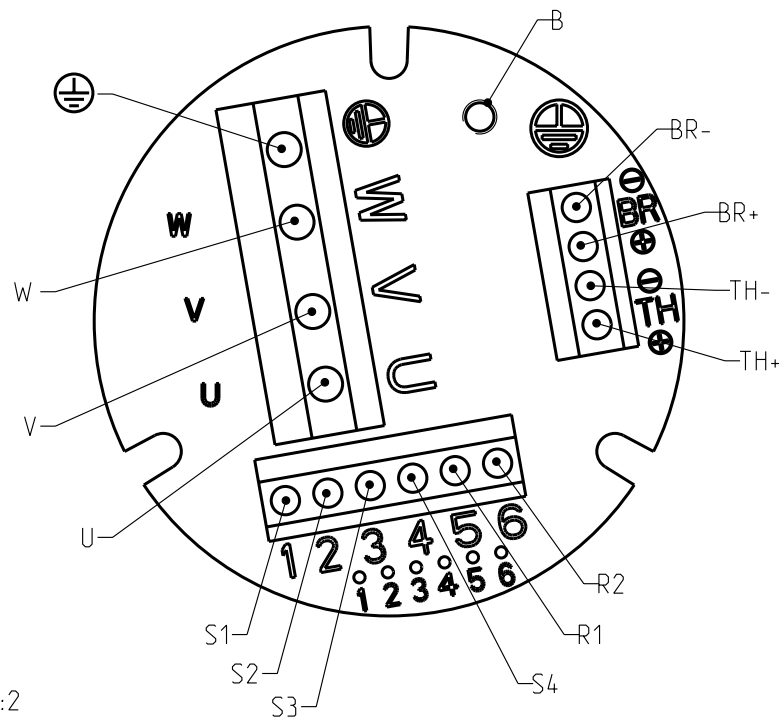

SCALE 3:2



Protection II 2 G EEx d II B T4 :  
 \* EN 50014 : GENERAL RULES  
 \* EN 50018 : FLAMEPROOF "d"  
 Certification : INERIS 03ATEX0060X

SHAFT END

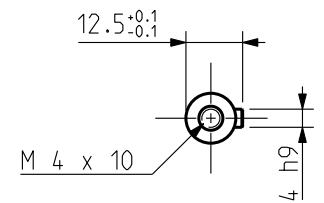

BRAKE

Supply voltage : 24V ±10%  
 Static torque

	EX310
20°C	2 Nm
100°C	1.8 Nm

Drawing valid for :

Weight :	Drawn	20/12/04	SP	Visa														
This document is the property of PARVEX. Transmission as well as reproduction or copy is not permitted without written authorisation.	Modifications																	
	a	AM 21877	le 03/02/05	SP														

Scale  
3:5



EX300  
 OUTLINE DRAWING

Format  
A3  
 344487AE1501 a