

Power cable gland EExdIIB :
Ø8.5-Ø16

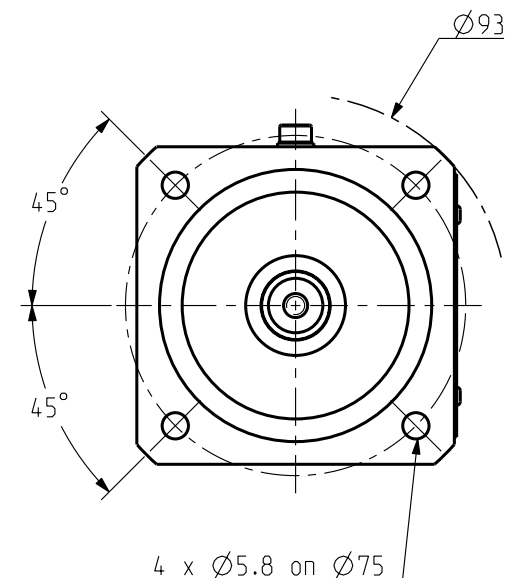

Sensor cable gland EExdIIB :
Ø6-Ø12

- U : Phase U
- V : Phase V
- W : Phase W
- TH- : Thermic protector
- TH+ : Thermic protector
- BR- : Brake -
- BR+ : Brake +
- S1 : Resolver 1
- S2 : Resolver 2
- S3 : Resolver 3
- S4 : Resolver 4
- R1 : Resolver 5
- R2 : Resolver 6
- B : Shield option (screw M3)
- ⊕ : Ground

PRINTED CIRCUIT
(under covering cap)

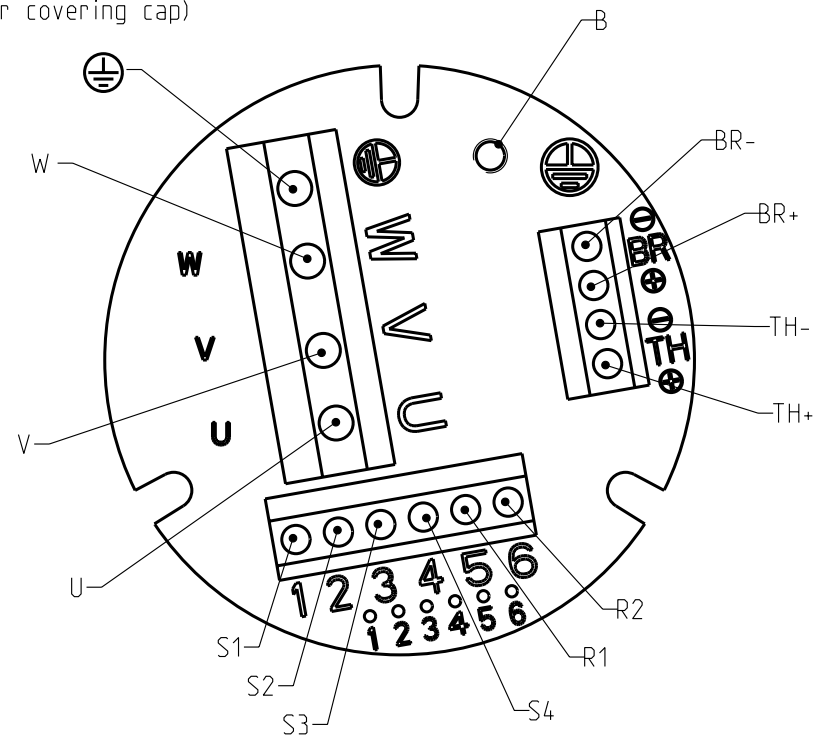

SCALE 3:2



Protection II 2 G EEx d II B T4 :
* EN 50014 : GENERAL RULES
* EN 50018 : FLAMEPROOF "d"
Certification : INERIS 03ATEX0060X

SHAFT END

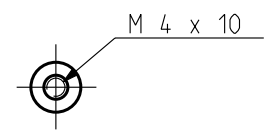

BRAKE

Supply voltage : 24V ±10%
Static torque

	EX310
20°C	2 Nm
100°C	1.8 Nm

Drawing valid for :

Weight :

This document is the property of PARVEX. Transmission as well as reproduction or copy is not permitted without written authorisation.

Drawn	22/12/04	SP	Visa					
Modifications								
	a	AM 21877 le 03/02/05	SP					

Scale 3:5

PARVEX
8 Avenue du lac. BP249
21007-DIJON cedex-FRANCE
www.parvex.com

EX300
OUTLINE DRAWING

Format	F	E	S	G	I	
A3	x	x				
344487AE1500						a